

Aufbauanleitung 12/2019

WERKZEUG:

Innensechskantschlüssel SW5 (beiliegend) und SW6

8x XS Stahldübel

8x Verbinder Gehäuse

8x Madenschrauben

1x Zylinderkopfschraube M 8x 70



1x Beilagscheibe

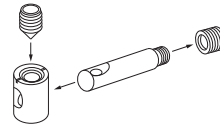

Funktionsvideo:
<https://www.youtube.com/watch?v=ioLUTDqtvgE>

Führen Sie den Aufbau des Tisches auf einer weichen Unterlage (z.B. einer Decke) aus, um Beschädigungen zu vermeiden.

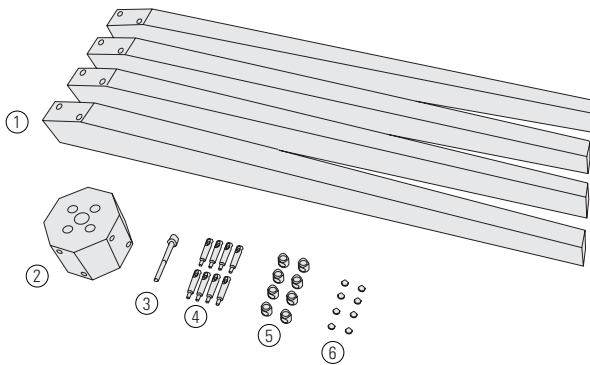

1 Füße

2 Zargenklotz

3 Zylinderkopfschraube m.
Beilagscheibe

4 XS Stahldübel

5 Verbindergehäuse

6 Madenschrauben

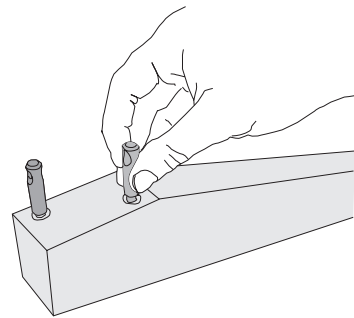

1. Die XS-Dübel eindrehen und dabei auf die vertikale Ausparung der Ausparung achten.

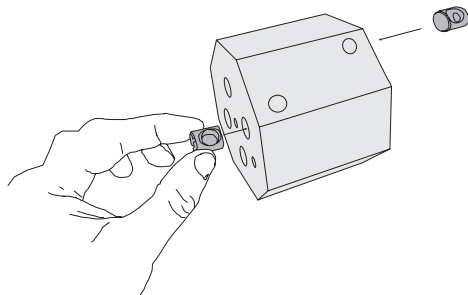

2. Verbindergehäuse in Zargenklotz stecken und auf richtige Ausrichtung achten.

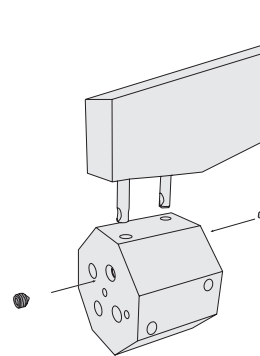

3. Füße an Zargenklotz stecken und Beschlag mit Madenschraube fest anziehen.

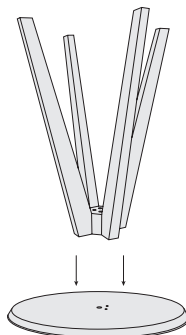

4. Das Gestell auf Platte stecken.

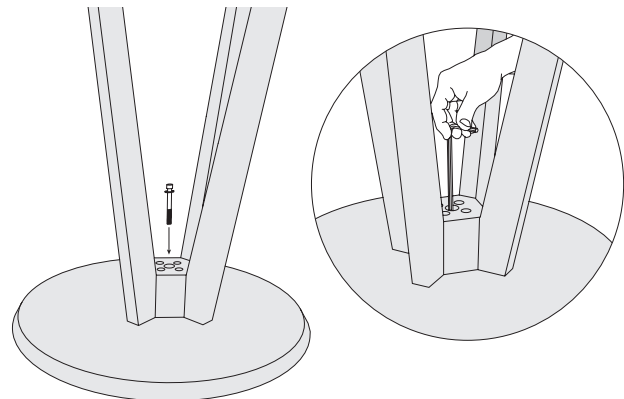

5. Gestell mit Zylinderkopfschraube befestigen.

CENA / CENA HIGH

ZEITRAUM

Assembly instructions 12/2019

tools:

allen screw SW5 (enclosed) and SW6

8x XS steel debs

8x boxes

8x grub screws

1x cylinder head bolt M 8x 70



1x disk

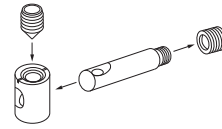

scheulenburg setup video :
<https://www.youtube.com/watch?v=iolUTDqtvgE>

Please do the setup of the table on a soft surface (e.g. a carpet or blanket) to avoid damages.

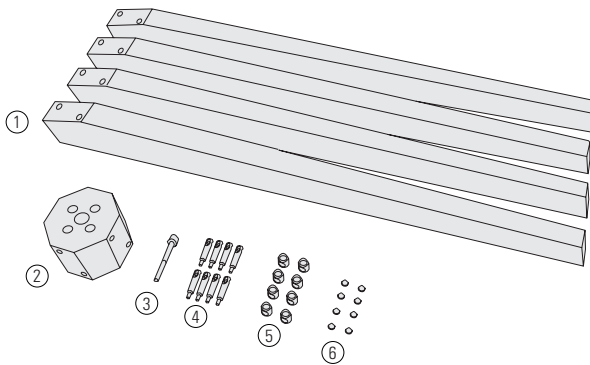

1 feet

2 frame

3 cylinder head bolt with disk

4 XS steel debs

5 boxes

6 grub screws

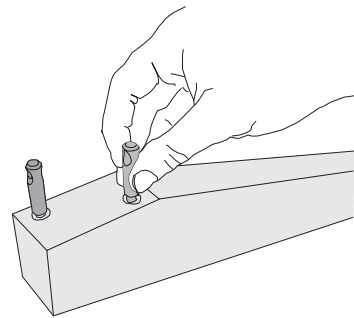

1. Screw in the XS steel debs and pay attention that the alignment of the holes is vertical.

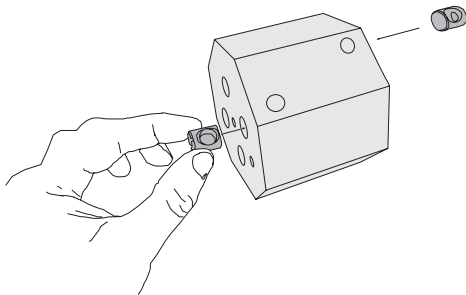

2. Insert the boxes in the frame and pay attention to the correct alignment.

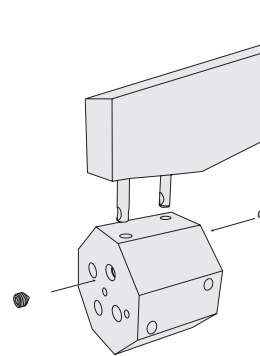

3. Put the feet on the frame and fix it with the grub screws tightly.

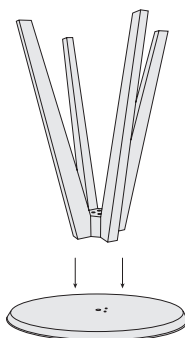

4. Place the frame on the plate.

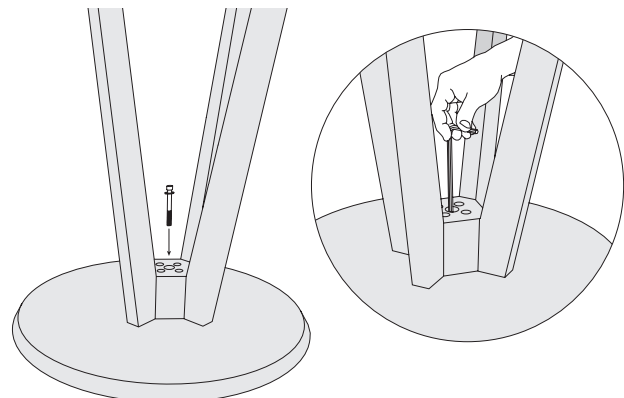

5. Fix the frame with the cylinder head bolt.